

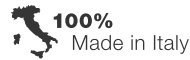

# BULL1524



control unit with incorporated receiver and virtual encoder  
personalised release key  
built-in battery charger



**up to 1500 kg**



## 24 Vdc | intensive use

- 24 Vdc geared motor with integrated control unit equipped with switching power supply (85÷265 Vac) which reduces energy consumption and ensures a long lifespan of the actuator
- Very intensive use, ideal for condominium applications
- Anti-crushing system with amperometric obstacle detection
- The control unit makes it possible to calculate the position of the motor starting from the measurement of instantaneous speed (virtual encoder)
- The virtual encoder allows proper management of the slowing-down phases, movement tracking (STC system), and torque management in relation to the position of the gate, which guarantees maximum safety
- Fast and easy to install, with the self-programming function through the radio transmitter, activation is possible immediately after installation
- Option to operate opposed sliding gates using the SIS accessory and in case of power failure with the built-in battery charger accessory
- Metal release lever



Foundation plate with anchor bolts included.  
Motor and floor fixing distance  
269 mm x 106 mm, no. 4 Ø 12 mm.

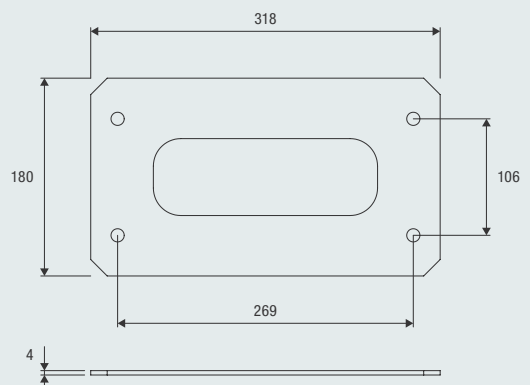
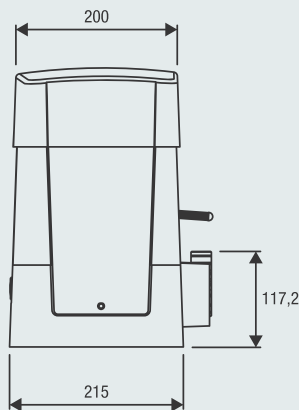
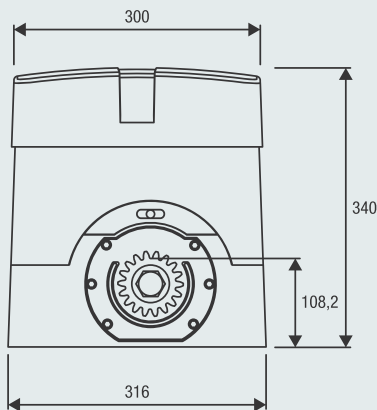

### COMPLETE KITS



MOTOR  
1x **BULL1524**



RACK  
8x **RI.M4P** [8 m]



TRANSMITTER  
2x **TO.GO4A**

**KBULL1524**

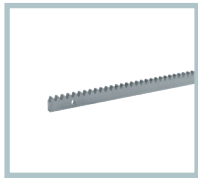

**RI.M4F**

M4 rack, to weld or attach with screws, 30x12x1000 mm slotted and galvanised. Supplied with M6 metric screws and threaded spacers.  
**Package of 4 pcs.**

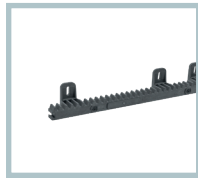

**RI.M4P**

Nylon rack with steel core, to attach with screws, M4, 28x40x1000 mm. Slotted, provided with self-drilling screws.  
**Package of 10 pcs.**



**SB.BULL20.F**

Externally fitted anti-intrusion cable unlock device (L=4.5m).



**MLS**

Magnetic limit switches.



**IRI.TX4VA**

4-channel transmitter with Advanced Rolling Code and Rolling Code.



**IRI.TX4AK**

4-channel transmitter with Advanced Rolling Code and Fixed Code.



**IRI.LAMP**

White full range flashing light, 20-255 Vac with built-in aerial.



**IRI.KPAD**

Battery operated wireless vandal-proof digital keypad with alert buzzer and backlit buttons. Triple coding: Rolling Code, Programmable Code and Advanced Rolling Code. 254 memorisable codes.



**BE.CODE**

Wireless battery operated keypad, with triple coding. Numerical membrane keypad to guarantee maximum activation sensitivity. It can memorise up to 254 PINs.



**IRI.CELL**

Pair of vandal-proof metal covers for PUPILLA/PUPILLA.R photocells, comprising front and rear shells with concealed screw. They can maintain perfect orientation over 180°.



**PUPILLA**

Pair of photocells adjustable to 180°. Option to synchronise up to 4 pairs, 24 Vac/dc power supply. Easy adjustment through a LED that signals optimal alignment. Compact size: 36x110x35 mm

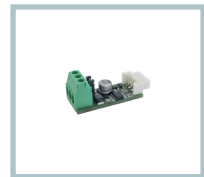

**SIS**

Quick connection electronic board that allows synchronised movement of 2 automation devices (opposed sliding gates). One board for each motor is necessary.

TECHNICAL DATA	BULL1524
Power supply	85 ÷ 265 Vac (50-60Hz)
Motor supply	24 Vdc
Max absorbed current	1.7 A
Max Thrust	944 N
Opening speed	11.7 m/min
Duty cycle	intensive use
Protection level	IP44
Operating temperature	-20°C /+50°C
Max gate weight	1500 kg
Driving gear for rack	M4 Z18
Weight	15.9 kg



**Beninca Australia Pty Ltd**  
 11/51 Owen St, Glendenning NSW 2761 AUSTRALIA  
 P + 61 2 9677 2827  
 info@BenincaAustralia.com.au

[licensed installer]